

# SAYA

## PIAZZA

SECTOR 131, NOIDA, WISH TOWN

THE ULTIMATE  
**SHOPPING**  
DESTINATION



Artistic Impression

# Elevate your shopping *Experience*



Saya Piazza in Sector 131 on Noida Expressway is all set to revolutionize the shopping experience. The mall is strategically located and close to a catchment area of 50,000+ families. Shoppers will be welcomed by the beautiful facade and ushered into the mall's luxurious ambience. Elaborately designed and embellished with supreme luxury, Saya Piazza is poised to be an epitome of leisure and commercial activities. Beyond grandeur, the structure will also reflect efficiency and offer a space for indulgence. Saya Piazza will offer a shopping experience so rich and unique, that everything else would seem ordinary.

*Caters to a large captive catchment.*



Artistic Impression



# DELIVERS 5,00000+ INDIVIDUALS



**1,60,000+**

An already bustling catchment of 1,60,000 people around Noida Expressway.



**1,00000+**

New homes and apartments on the Noida Expressway by 2022.



**10,000+**

Vehicles expected to ply the 6 and 8 lane e-way by 2022. Saya Piazza is right at the centre of all the action.

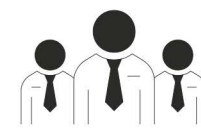

**85,000+**

People work in corporates across Noida Expressway.



**100+**

Educational institutes in close vicinity.

*The luxury of  
meticulous planning*



Artistic Impression



The conception of Saya Piazza brings with it a design philosophy that creates a superior experiential space. The imposing facade that rises over the structure is designed to make a grand impression, one that will welcome people to step into its luxurious confines. Elegant lines, tasteful landscaping and beautiful lighting will be the hallmarks of this impressive landmark.

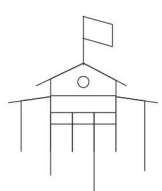

**Schools & Colleges**

Operational and in close proximity:  
Amity University, Step by Step,  
Shiv Nadar, Pathways, Presidium, etc.



**1162+ Acres**

Integrated township



Saya Piazza

the only organised plaza for

**50,000+ Families**

(About 2 lakh people)



200 acre

**18+9 Hole**

Golf course



**1 Lakh+**

People working in MNCs  
like Axis Bank, GE, TCS, Accenture,  
Adobe, HCL, Samsung, KPMG, etc.

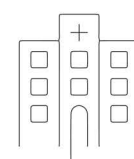

**500 Bed**

State-of-the-art  
Jaypee Hospital operational.

# THE LOCATION



# BASEMENT FLOOR PLAN



# LOWER GROUND FLOOR PLAN

Height 13'



# GROUND FLOOR PLAN

**Height 20'**

- FOODY ZONE**
- SHOPS**

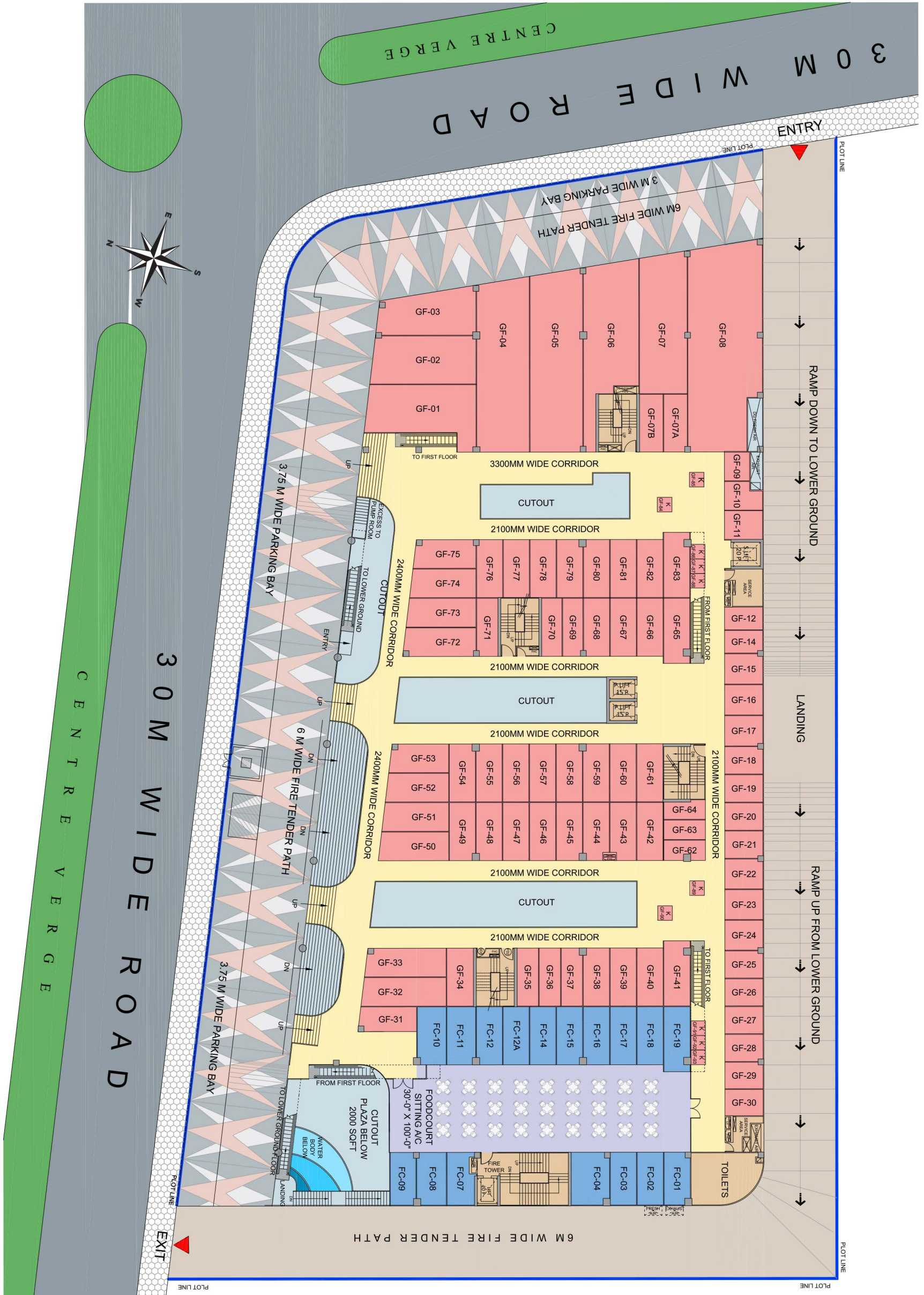

Disclaimer: Visual representation shown in the brochure are purely conceptual. All building Plans, Specifications, Layout Plans, Information etc. are tentative and subject to variation & modification by the company or the competent authority.



# FIRST FLOOR PLAN

Height 14'

FOODY ZONE  
SHOPS



Disclaimer: Visual representation shown in the brochure are purely conceptual. All building Plans, Specifications, Layout Plans, Information etc. are tentative and subject to variation & modification by the company or the competent authority.

# SECOND FLOOR PLAN

Height 14'

FOODY ZONE  
SHOPS



# THIRD FLOOR PLAN

Height 15'

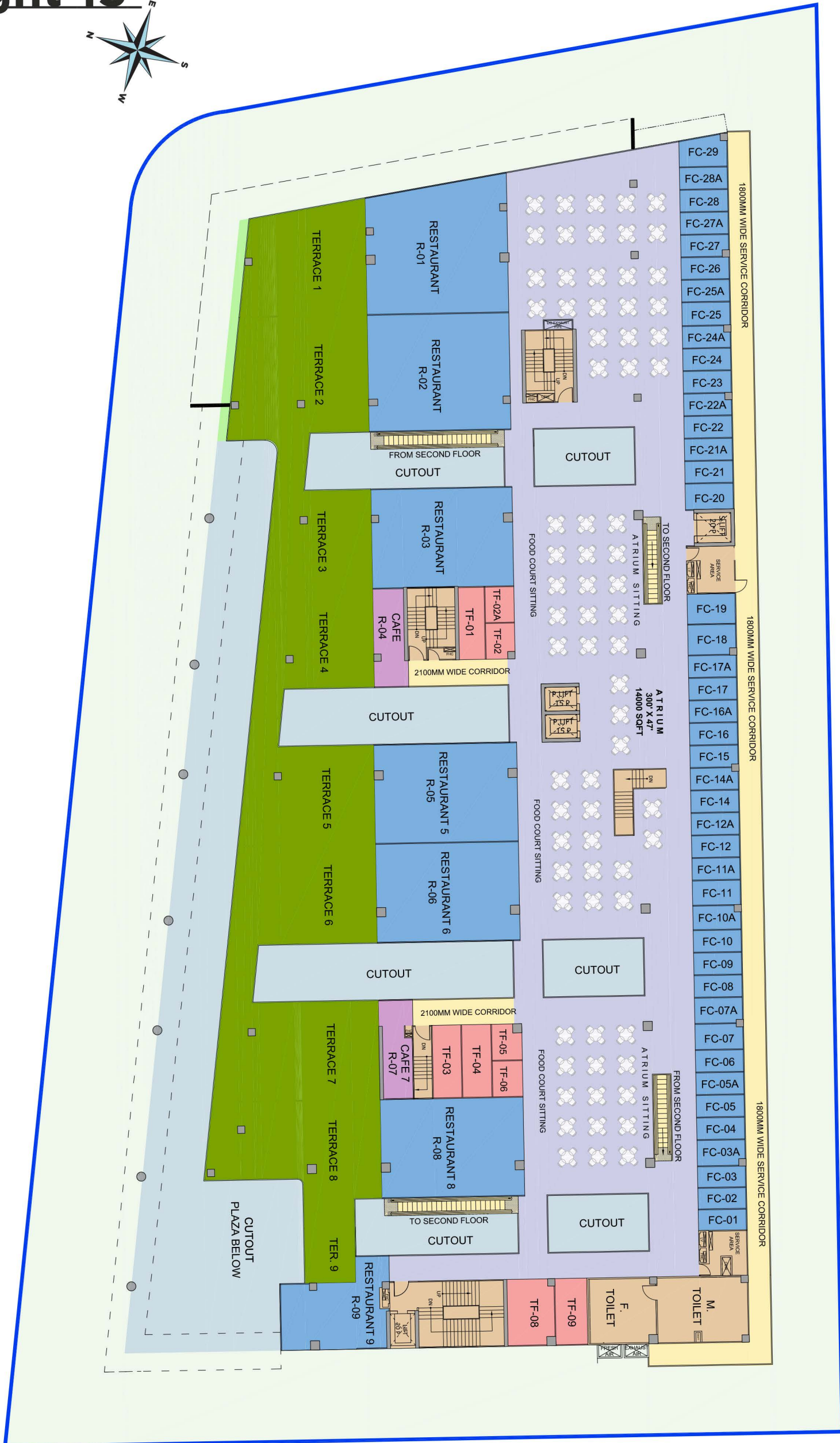
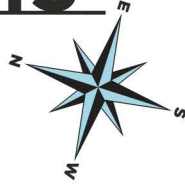

Disclaimer: Visual representation shown in the brochure are purely conceptual. All building Plans, Specifications, Layout Plans, Information etc. are tentative and subject to variation & modification by the company or the competent authority.

# SAYA

## PIAZZA

SECTOR 131, NOIDA, WISH TOWN

EXPERIENCE  
OF MORE THAN  
**2 DECADES**

OVER  
**5.7 MILLION\***  
**SQ.FT.**  
DELIVERED

MORE THAN  
**4000**  
SATISFIED FAMILIES

**6 DEVELOPMENTS**  
IN RESIDENTIAL  
& COMMERCIAL



### THE JOURNEY OF 2 DECADES

## WE WELCOME YOU AT OUR CORPORATE OFFICE

Plot No. C-3A, Sector 129, Near Genesis Global School,  
Noida - 201306, Uttar Pradesh

#### RGB Infra LLP

Visit [www.sayahomes.com](http://www.sayahomes.com)

Email [commercial@sayahomes.in](mailto:commercial@sayahomes.in)

#### Site Office

Plot No. C1-C2, Sector 131, Noida

#### Registered Office

0-24B, Basement, Jungpura Extension,  
New Delhi-110014

E : [info@sayahomes.in](mailto:info@sayahomes.in) | W : [www.sayahomes.com](http://www.sayahomes.com)

RERA NO.: UPRERAPRJ364061 | [www.up.rera.in](http://www.up.rera.in)



The Project is funded and mortgaged with IIFL Home Finance Ltd. and No Objection Certificate for the sale of flats of the project is required to be taken from IIFL Home Finance Ltd.